

Tryck på Esc för att stänga helskärmen



Najad 511 Aphrodite

For many years, cruiser design has taken its inspiration from racing. This caused us to think "Why not take a completely different tack?"

That is, build new yachts that evoke the esthetic of yesteryear but that take full advantage of modern-day technology.

Which is exactly what we did. We created a completely new range of Aphrodite yachts, for people who appreciate classic beauty and are looking for something out of the ordinary.

The legacy from the legendary yachts built on the Swedish island of Orust is plain to see. The hull's soft sweeping forms are a pleasure to the eye. A deck of teak is just as obvious a choice as a superstructure of mahogany. Old-fashioned fresh air vents and a wooden steering wheel are details that make for an attractive overall look. A solid construction in every respect ensures a smooth and stable passage through the water. Rig and hardware are first rate.

Down in the cabin you'll find quality craftsmanship, executed with extreme attention to detail. A classically designed mahogany interior. Cosy but light, with unsurpassed comfort. Lighting fittings and hardware of brass have just the right feel. Dimensions are generous and the layout is particularly well considered. It's a place where you'll be happy to spend time.

Aphrodite are yachts for a small and exclusive set of sailors, a select group of boat lovers who value tradition and history.

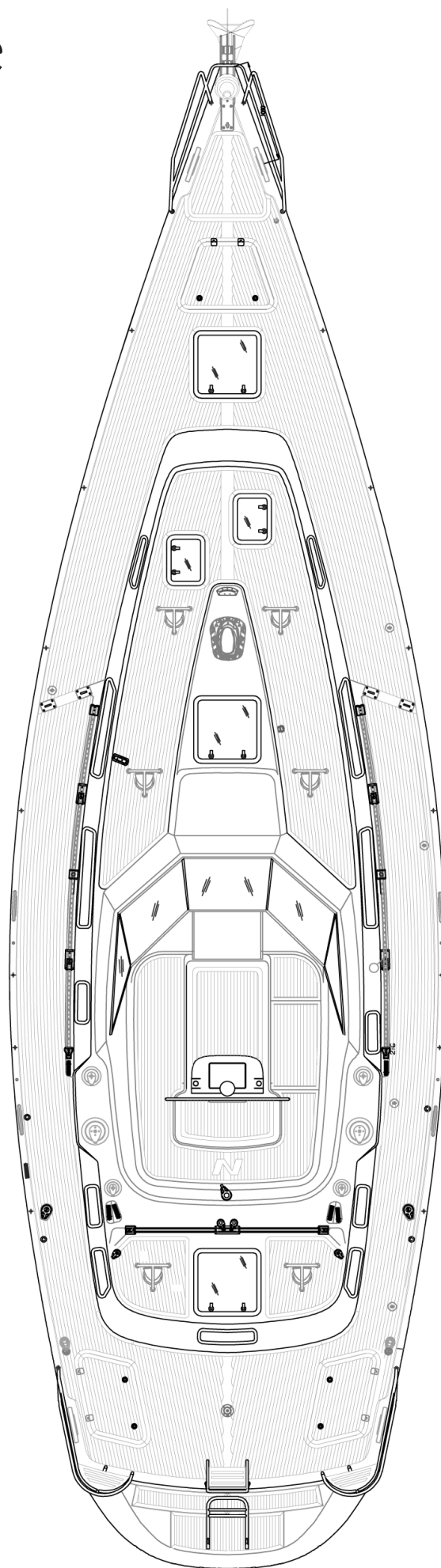

Najad 511 Aphrodite

Under många år har Cruiser designen tagit sin inspiration från racing. Detta fick oss att tänka "Varför inte ta en helt annan linje?"

Det vill säga bygga nya båtar som väcker den estetiska från förr, men att dra full nytta av dagens teknik. Vilket är precis vad vi gjorde. Vi skapade en helt ny serie Aphrodite båtar, för människor som uppskattar klassisk skönhet och letar efter något utöver det vanliga.

Arvet från de legendariska båtar byggda på den svenska ön Orust är lätt att se. Skrovets mjuka svepande former är en fröjd för ögat. En däck av teak är lika självklart val som en överbyggnad av mahogny. Gammaldags friskluftsventiler och en läder ratt är detaljer som gör för en attraktiv övergripande utseende. En solid konstruktion i alla avseenden ger en jämn och stabil passage genom vattnet. Rigg och hårdvara är av högsta klass.

Nere i kabinen hittar du hantverk av bästa kvalitet, utfört med extrem uppmärksamhet på detaljer. En klassiskt designad mahogny inredning. Mysigt men ljus, med oöverträffad komfort.

Belysningsarmatur och hårdvara i mässing har precis rätt känsla. Dimensionerna är generösa och layouten är speciellt väl genomtänkt. Det är en plats där du ska vara glad att spendera tid.

Afrodite är båtar för en liten och exklusiv uppsättning sjömän, en utvald grupp av båt älskare som värdesätter tradition och historia.

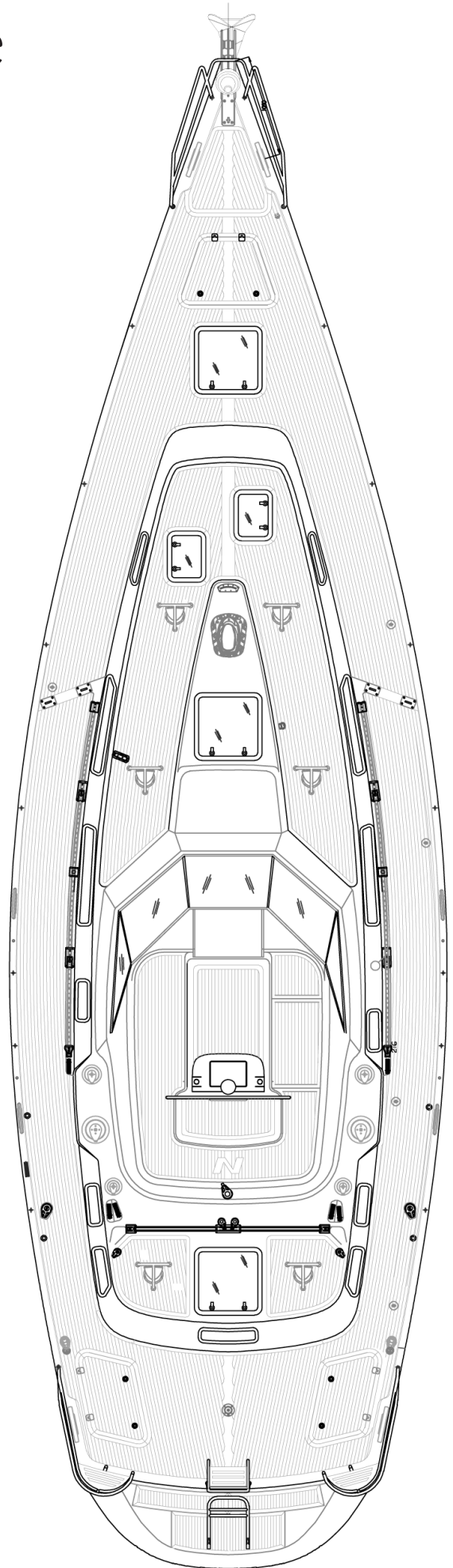

Najad 511 Aphrodite

Viele Jahre ließen sich die Yachtdesigner von Regattabooten inspirieren. Dies veranlaßte uns zu der Überlegung “Warum nicht einmal einen völlig neuen Weg gehen?”

Soll heißen, neue Yachten zu bauen mit wieder zum Leben erweckter alter Ästhetik ohne die moderne Technik außer Acht zu lassen.

Und genau das machten wir. Wir entwickelten eine völlig neue Serie von Aphroditeyachten, für die Menschen, die die klassische Schönheit schätzen und nach etwas Besonderem suchen.

Das Erbe der legendären, auf der schwedischen Insel Orust gebauten Yachten ist nicht zu übersehen. Die geschwungenen Formen erfreuen das Auge. Der Aufbau kombiniert aus Teak und Mahagony, traditionelle Ventilatoren und ein hölzernes Steuerrad verhelfen dieser Yacht zu einem außergewöhnlich attraktiven Aussehen. Sowohl eine solide Konstruktion in allen Bereichen als auch die Wahl von erstklassigem Rigg und Beschlägen gewährleisten ein fantastisches Segelerlebnis.

Unter Deck findet man erstklassiges Mahagonyinterieur im klassischen Design, bei dessen Verarbeitung großes Augenmerk aufs Detail gelegt wurde. Eine gemütliche und helle Atmosphäre mit unübertroffenem Komfort. Die Armaturen und Messingteile sind passend aufeinander abgestimmt, alles ist großzügig geplant und sich hier wohlfühlen fällt wirklich nicht schwer.

Die Aphroditeyachten sind für eine kleine Liebhabergruppe unter den Seglern gedacht, die Wert legen auf Tradition und Geschichte.

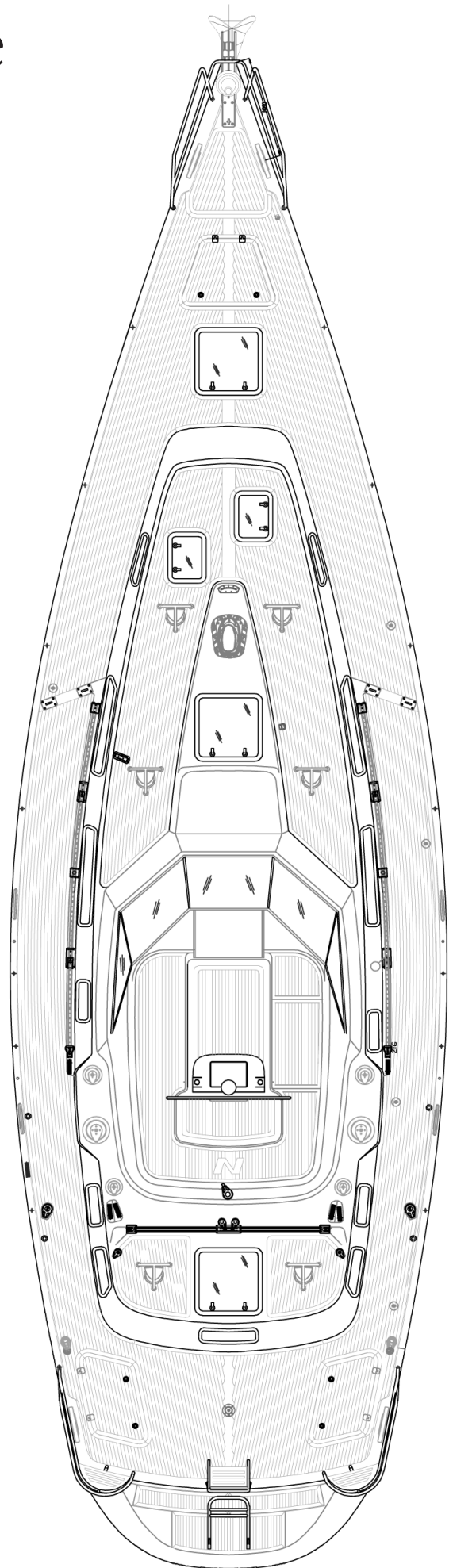

NAIAD

Aphrodite line

N 380 - *Aphrodite*

N 460 - *Aphrodite*

N 511 - *Aphrodite*

Aphrodite Line

For many years, cruiser design has taken its inspiration from racing. This caused us to think "Why not take a completely different tack?"

That is, build new yachts that evoke the esthetic of yesteryear but that take full advantage of modern-day technology.

Which is exactly what we did. We created a completely new range of Aphrodite yachts, for people who appreciate classic beauty and are looking for something out of the ordinary.

The legacy from the legendary yachts built on the Swedish island of Orust is plain to see. The hull's soft sweeping forms are a pleasure to the eye. A deck of teak is just as obvious a choice as a superstructure of mahogany. Old-fashioned fresh air vents and a wooden steering wheel

are details that make for an attractive overall look. A solid construction in every respect ensures a smooth and stable passage through the water. Rig and hardware are first rate.

Down in the cabin you'll find quality craftsmanship, executed with extreme attention to detail. A classically designed mahogany interior. Cosy but light, with unsurpassed comfort. Lighting fittings and hardware of brass have just the right feel. Dimensions are generous and the layout is particularly well considered. It's a place where you'll be happy to spend time.

Aphrodite are yachts for a small and exclusive set of sailors, a select group of boat lovers who value tradition and history.

Welcome on board.

Semi Custom Build

Your new boat is our next project.

Over the past 37 years Najad has gone through many developments, but one thing always has been clear to us: No customer is the same. Therefore we at Najad strongly believe and have specialized ourselves in the concept of Semi Custom Build.

For you as our customer this means that from the very first contact with a member of our sales team, throughout the process of order, specification, build, delivery and after sales, everything in our organization is focused on meeting your personal wishes.

Personalization already starts with the offer we make you. We do not believe in standard option- and pricelists. Our sales people will discuss in detail with you how and where you will use your boat and what you expect from your Najad. Based on your wishes you will receive a fully detailed customized offer.

After ordering your own Najad one of our project

managers will take over from our sales team. Often you already have met your project manager during the ordering process for discussing the possibilities of certain wishes. Your project manager is your link to the entire Najad organization. He or she will guide you along each step of detailed specification, build and delivery of your boat. If special drawings or calculations are required our experienced team of engineers will take care of this.

Each boat we build is a special project for us at Najad. Meeting customer's wishes requires a high level of development in design and technology within our organization. Our designers and engineering specialists will see to it that your personal ideas are integrated in the Najad concept in the very best way. Without compromising on safety or beauty and always meeting our own strict quality demands and those of Germanischer Lloyd.

N 380 - *Aphrodite*

*"I shall go the way of the open sea, To the lands I knew before
you came, And the cool ocean breezes shall blow from me,
The memory of your name."*

Laurence Hope



DIMENSIONS AND DATA

Length overall 11,55 m

Length waterline 9,90 m

Beam 3,65 m

Draught 1,95 m*

Alternative draught 1,65 m

Displacement 9.1 t

Bolted keel 3,1 t

Mast height above water line 17,75 m

Headroom in saloon 1,95 m

Total height for transportation 4,15 m

ENGINE

Power 41 kW, 55 h.p.

TANKS Stainless steel

Water capacity 400 l

Hot water heater 20 l

Fuel capacity approx. 325 l

Holding capacity 55 l

SAIL AREAS

Cruising 75,3 m²

Main 41,8 m²

Working jib 33,5 m²*

Furling Genoa 44,0 m²*

Storm jib 14,0 m²*

Spinnaker 115,0 m²*

Gennaker 98,0 m²*

*Extra equipment













N 460 - *Aphrodite*

"I find the great thing in this world is not so much where we stand, as in what direction we are moving: To reach the port of heaven, we must sail sometimes with the wind and sometimes against it, but we must sail, and not drift, nor lie at anchor."

Oliver Wendell Holmes



DIMENSIONS AND DATA

Length overall 13,95 m

Length waterline 11,88 m

Beam 4,28 m

Draught 2,15 m

* Alternative draught 1,90 m

Displacement 15,5 t

Bolted keel 5,4 t

Mast height above water line 19,80 m

Headroom in saloon 1,97 m

Total height for transportation 4,50 m

ENGINE

Power 55 kW, 75 h.p.

TANKS

Stainless steel

Water capacity 565 l

Hot water heater 40 l

Fuel capacity approx. 460 l

Holding capacity 150 l

SAIL AREAS

Cruising 99,0 m²

Full-batten main 53,0 m²

Working jib 46,0 m²

* Furling Genoa 64,5 m²

* Spinnaker 165,0 m²

* Gennaker 135,0 m²

*Extra equipment

N 511 - *Aphrodite*

"Twenty years from now you will be more disappointed by the things that you didn't do than by the ones you did do. So throw off the bowlines. Sail away from the safe harbor. Catch the trade winds in your sails. Explore. Dream. Discover."

Mark Twain



DIMENSIONS AND DATA

Length overall 15,50 m

Length waterline 13,4 m

Beam 4,50 m Draught 2,40 m

* Alternative draught 2,05 m

Displacement 19,0 t

Bolted keel 6,3 t

Mast height above water line 22,15 m

Headroom in saloon 1,98 m

Total height for transportation 4,80 m

ENGINE

Power 81 kW, 110 h.p.

TANKS Stainless steel

Water capacity 630 l

Hot water heater 60 l

Fuel capacity approx. 615 l

Holding capacity 140 l

SAIL AREAS

Cruising 129,0 m²

Full-batten main 71,0 m²

Working jib 458,0 m²

* Furling Genoa 79,0 m²

* Spinnaker 195,0 m²

* Gennaker 168,0 m²

*Extra equipment



*Najadvarvet AB, Box 10, 473 21 Henån, Sweden,
Tel. +46 (0)304 692 300, Fax. +46 (0)304 692 301, info@najad.se, www.najad.se*

*Najad Yachts UK Ltd, Hamble Point Marina, School Lane, Hamble, SO31 4NB, England
Tel +44 2380 455 555, Fax: +44 2380 455 450, info@najad.com, www.najad.com*

Photo: Nicky Bomby. This brochure is for promotional purpose only and cannot form part of any contract or offer.
Najadvarvet AB will not be held responsible for the consequences of any error or omissions. Pictures and illustrations are liable to show non-standard equipment.



APHRODITE IS PART OF THE LINNÉA YACHT GROUP.

The Linnéa Yacht Group creates a stable structure in the Scandinavian yacht industry, providing a financially sound, long-term platform for the brands currently included in the group: Najad, Maxi Yachts and Aphrodite.

The Linnéa Yacht Group also develops new services and product groups that enhance accessibility for the yacht owners. The group has its headquarters on the Swedish island of Orust. Its annual sales total 40 million Euros.

APHRODITE
2009

APHRODITE 2009.

VINTAGE DESIGN WITH CUTTING-EDGE TECHNOLOGY.

For many years, cruiser design has taken its inspiration from racing. This caused us to think “Why not take a completely different tack?” That is, build new yachts that evoke the esthetic of yesteryear but that take full advantage of modern-day technology.

Which is exactly what we did. We created a completely new range of Aphrodite yachts, for people who appreciate classic beauty and are looking for something out of the ordinary.

The legacy from the legendary yachts built on the Swedish island of Orust is plain to see.

The hull’s soft sweeping forms are a pleasure to the eye. A deck of teak is just as obvious a choice as a coachroof covered in mahogany. Old-fashioned fresh air vents and a wooden steering wheel are details that make for an attractive overall look. A solid construction in every respect ensures a smooth and stable passage through the water. Rig and hardware are first rate.

Down in the cabin you’ll find quality craftsmanship, executed with extreme attention to detail. A classically designed mahogany interior. Cosy but light, with unsurpassed comfort. Lighting fittings and hardware of brass have just the right feel. Dimensions are generous and the layout is particularly well considered. It’s a place where you’ll be happy to spend time.

Aphrodite are yachts for a small and exclusive set of sailors, a select group of boat lovers who value tradition and history.

Welcome on board.

LINNÉA YACHT GROUP

Varussågen 1 • 473 31 Henån • Sweden • Phone +46 (0)304 692 300 • Fax +46 (0)304 692 301 • www.linneayachtgroup.se • info@linneayachtgroup.se

Aphrodite



Dimensions and data

Length overall 11.55 m
Length waterline 9.90 m
Beam 3.65 m
Draught 1.95 m
* Alternative draught 1.65 m
Displacement 9.1 t
Bolted keel 3.1 t
Mast height above water line 17.75 m
Headroom in saloon 1.95 m
Total height for transportation 4.15 m

Gelcoat

Hull Ashland GN 10 000
Deck Ashland GN 10 000

Technical

Engine, 41 kW, 55 h.p.
Tanks in stainless steel
Water capacity approx. 400 l
Hot water heater 20 l
Fuel capacity approx. 325 l
Holding capacity 55 l

Sail areas

Cruising 75.3 m²
Main 41.8 m²
Working jib 33.5 m²
* Furling Genoa 44.0 m²
* Storm jib 14.0 m²
* Spinnaker 115.0 m²
* Gennaker 98.0 m²

* Extra equipment

APHRODITE 38

*“I shall go the way of the open sea, To the lands I knew before you came,
And the cool ocean breezes shall blow from me, The memory of your name.”*

Laurence Hope





APHRODITE 46

“I find the great thing in this world is not so much where we stand, as in what direction we are moving: To reach the port of heaven, we must sail sometimes with the wind and sometimes against it, but we must sail, and not drift, nor lie at anchor.”

Oliver Wendell Holmes

Dimensions and data Length overall 13.95 m Length waterline 11.88 m Beam 4.28 m Draught 2.15 m * Alternative draught 1.90 m Displacement 15.5 t Bolted keel 5.4 t Mast height above water line 19.80 m Headroom in saloon 1.97 m Total height for transportation 4.50 m	Gelcoat Hull Ashland GN 10 000 Deck Ashland GN 10 000	Technical Engine, 55 kW, 75 h.p. Tanks in stainless steel Water capacity appr. 565 l Hot water heater 40 l Fuel capacity appr. 460 l Holding capacity 150 l	Sail areas Cruising 99.0 m² Full-batten main 53.0 m² Working jib 46.0 m² * Furling Genoa 64.5 m² * Spinnaker 165.0 m² * Gennaker 135.0 m²
* Extra equipment			





APHRODITE 51

“Twenty years from now you will be more disappointed by the things that you didn’t do than by the ones you did do. So throw off the bowlines. Sail away from the safe harbor. Catch the trade winds in your sails. Explore. Dream. Discover.”

Mark Twain

Dimensions and data

Length overall 15.50 m
Length waterline 13.4 m
Beam 4.50 m
Draught 2.40 m
* Alternative draught 2.05 m
Displacement 19.0 t
Bolted keel 6.3 t
Mast height above water line 22.15 m
Headroom in saloon 1.98 m
Total height for transportation 4.80 m

Gelcoat

Hull Ashland GN 10 000
Deck Ashland GN 10 000

Technical

Engine, 81 kW, 110 h.p.
Tanks in stainless steel
Water capacity approx. 630 l
Hot water heater 60 l
Fuel capacity approx. 615 l
Holding capacity 280 l

Sail areas

Cruising 129.0 m²
Full-batten main 71.0 m²
Working jib 58.0 m²
* Furling Genoa 79.0 m²
* Spinnaker 195.0 m²
* Gennaker 168.0 m²

* Extra equipment



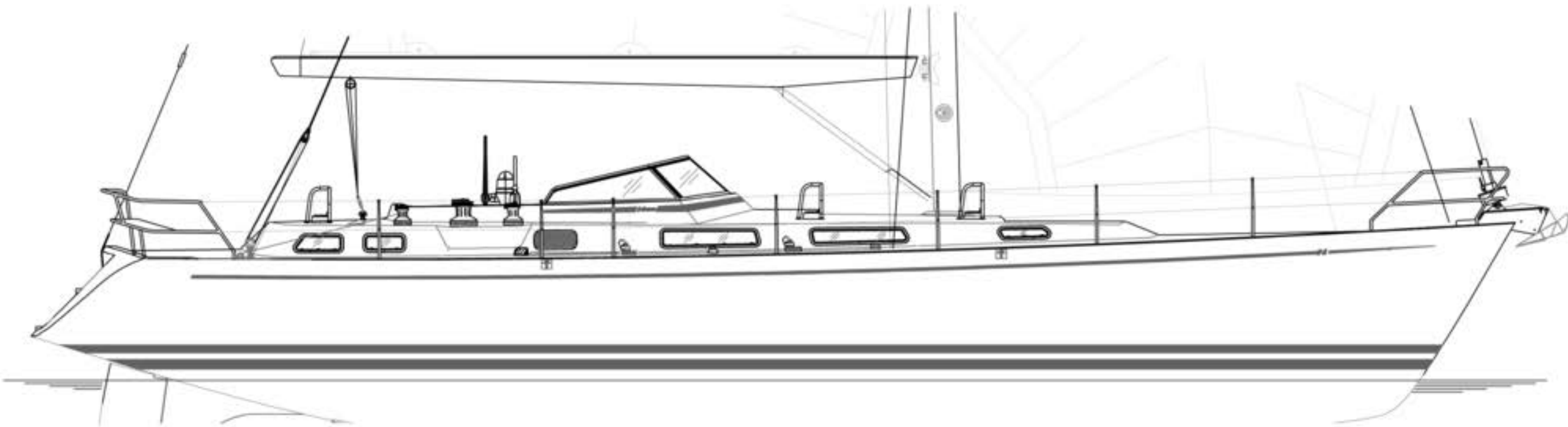

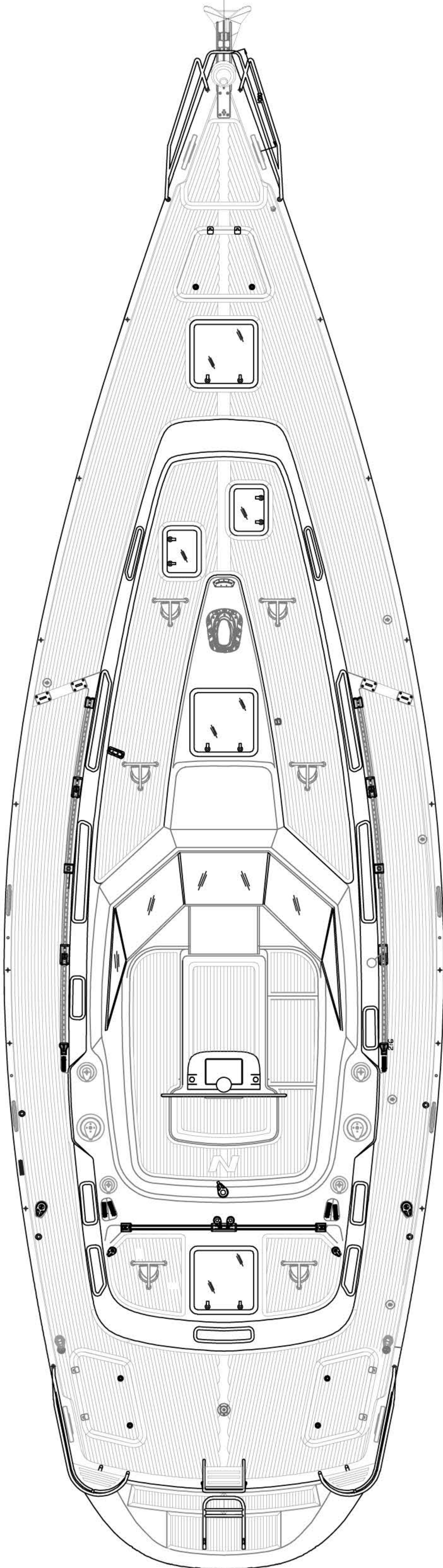

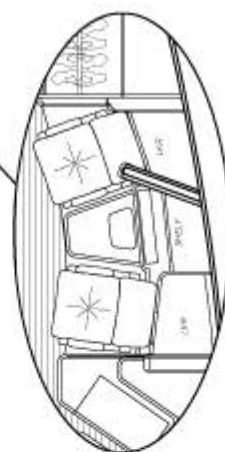
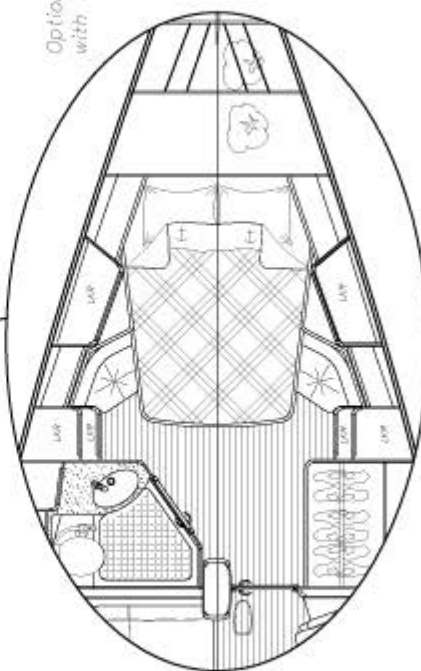
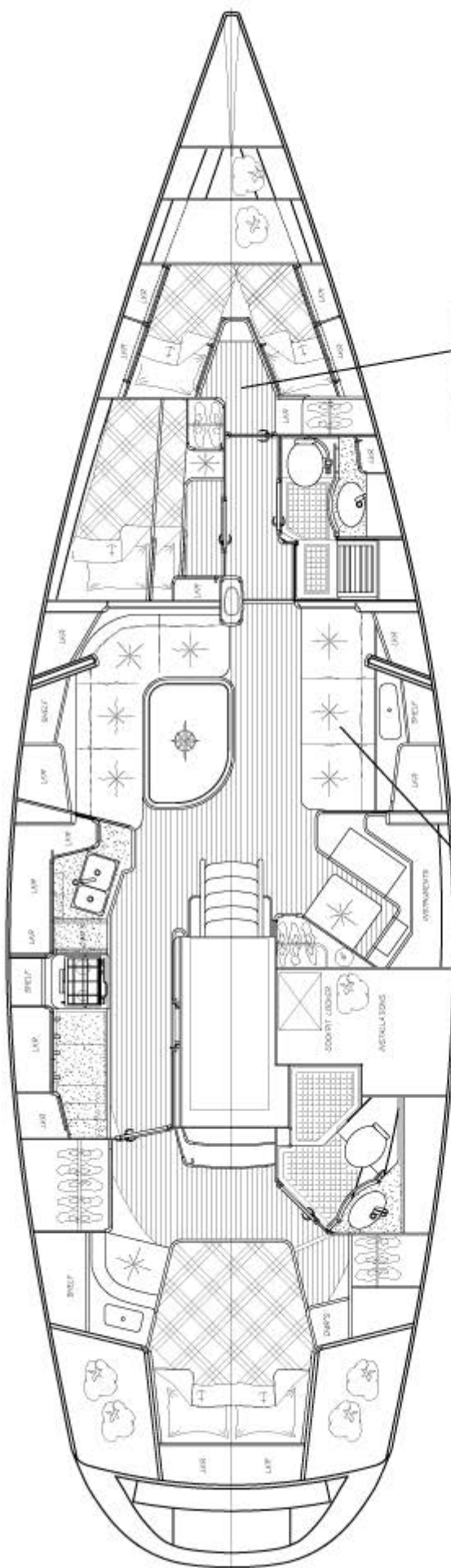

Najad 511 - 511 Aphrodite Line

